

# REFORM 30 IN-OUT RECESSED

## Installation Manual

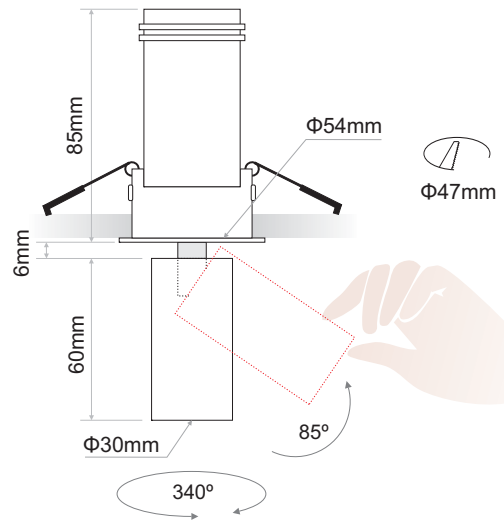

### To pull OUT the spot

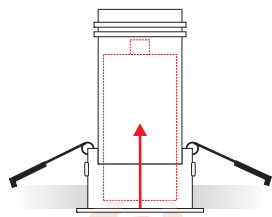
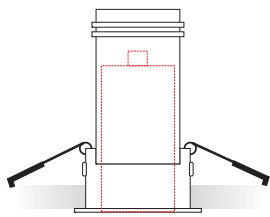

1. Push in the spot.

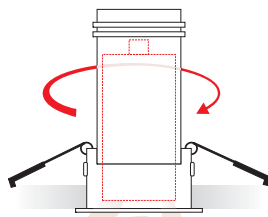

2. Turn the spot left to unlock.

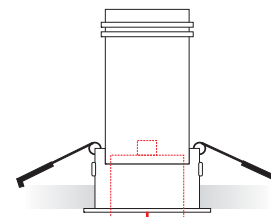

3. Once the spot is unlocked pull it downwards to the desired level.

### To pull IN the spot

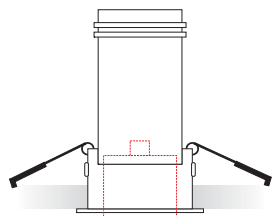
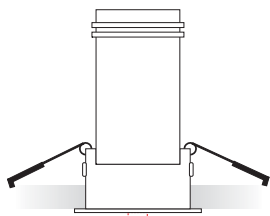

1. Push the spot inside.

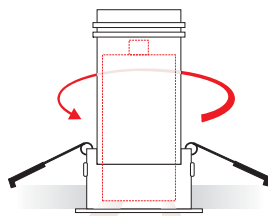

2. Once all the spot is inside then turn the spot right.

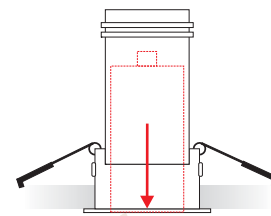

3. Release the spot to lock.

# REFORM 30 IN-OUT RECESSED

Installation Manual



1



### Attention

Before any maintenance switch off the main power.

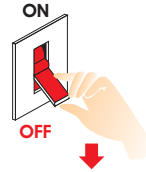

2

2.1

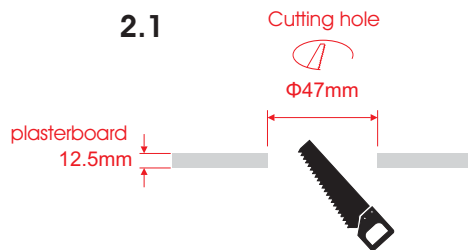

2.2

Connect the LED Driver at 230VAC.

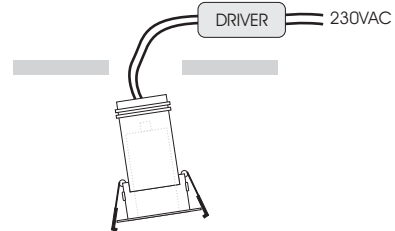

3

3.1

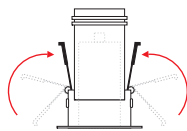

3.2

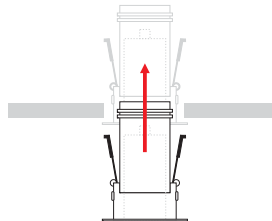

3.3

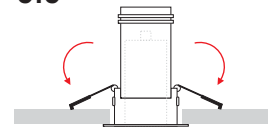

4

